

# DARIEN PUBLIC SCHOOLS

## Contemplated Gift Form

Gift intended for:  
(Check appropriate responses)

Person(s) or Group Offering Gift(s)

- Hindley  
 Holmes  
 Ox Ridge  
 Royle  
 Tokeneke  
 Middlesex Middle School  
 Darien High School  
 District

Hindley School PTO

Contact person

Name Rita Ferri  
Address 10 Nearwater Lane  
Darien, CT 06820

Tele. 203.655.1323

Fax. 203.655.7024

e-mail [rferri@darienps.org](mailto:rferri@darienps.org)

Description of proposed gift(s), including the form in which it (they) will be given (e.g. money, materials, services, etc.) and for what purpose(s). The description has to be sufficiently specific to allow administration to determine whether items 2, 3, or 4 of the guidelines specified in "Administration Regulation JG-Public Gifts to the Schools" apply.

See attached

**Please answer the following questions.**

Is the value of the gift(s) \$ 500.00 or more?     Yes     No

Note: If the proposed gift involves donated materials or services please place an estimated dollar value on them.

If your answer to the previous question is Yes please check one of the following categories of value for the proposed gift(s):

- |                                      |   |
|--------------------------------------|---|
| <input type="checkbox"/> 500-1,000   | <input type="checkbox"/> 5,000-10,000       |
| <input type="checkbox"/> 1,000-2,000 | <input type="checkbox"/> 10,000-15,000      |
| <input type="checkbox"/> 2,000-3,000 | <input type="checkbox"/> 15,000-20,000      |
| <input type="checkbox"/> 3,000-4,000 | <input checked="" type="checkbox"/> 20,000+ |
| <input type="checkbox"/> 4,000-5,000 |   |

Do not write below this line

Status: Date received by Superintendent \_\_\_\_\_

Notes on actions by Superintendent of Schools-

Actions, if any, by the Board of Education-

Final disposition of the gift offer-



**M.E. O'Brien & Sons, Inc.**  
93 West Street – P.O. Box 650 / Medfield, MA 02052  
Phone: 508-359-4200 / Fax: 508-359-2817  
SDO CERTIFIED WBE (MA ONLY)

## REVISED QUOTE

Date: February 10, 2016

Page 1 of 2

Job: Hindley Elementary School

Location: Darien, CT

Salesman: Peter Wallace, CPSI / Phone: 203-805-4325 / Fax: 203-805-4265  
Peter\_Wallace@obrienandsons.com

Attention: Sheila Molloy / sheilammolloy@gmail.com  
Amanda Smith / adsmith610@gmail.com  
Mike Lynch / mlynch@darienps.org

We are pleased to offer our quotation on the following for the above subject job:

<u>QTY</u>	<u>DESCRIPTION</u>	<u>TOTAL</u>
	<u>As Manufactured by Landscape Structures, Inc.</u>	
	<u>#MEO16072</u>	
1	#194663A ZipKrooz	\$10,225.00
1	#193176A Boogie Board , independent	\$2,125.00
1	#205800A TopsyTurny Spinner	\$4,300.00
	Installation of above three components and relocation of climbing wall and triple ring fling attached to existing structure	\$7,800.00
	<u>Installation Services to include:</u>	
	<ul style="list-style-type: none"><li>• Excavation as required for new equipment, 12" deep</li><li>• Receive and off-load equipment delivery</li><li>• Lay out and augur holes</li><li>• Install new equipment</li><li>• Spread Engineered Woodfiber (supplied by the Town)</li><li>• Re-locate existing climbing wall and triple ring fling attached to existing structure</li></ul>	

SEE IMPORTANT NOTES ON PAGE 2.



The NSM Certified logo is a mark of the NSM Certified program. It is a mark of the NSM Certified program. It is a mark of the NSM Certified program. It is a mark of the NSM Certified program.

THIS PLAY AREA & PLAY EQUIPMENT IS DESIGNED FOR AGES 5-12 YEARS UNLESS OTHERWISE NOTED ON PLAN.

IF IS THE MANUFACTURER'S OPINION THAT THIS PLAY AREA DOES CONFORM TO THE ADA ACCESSIBILITY STANDARDS, THE MANUFACTURER'S OPINION SHOULD BE PROVIDED AS INDICATED OR WITHIN THE ENTIRE USE ZONE.

THIS CONCEPTUAL PLAN WAS BASED ON THE MANUFACTURER'S OPINION AND THE MANUFACTURER'S OPINION SHOULD BE PROVIDED AS INDICATED OR WITHIN THE ENTIRE USE ZONE. THIS CONCEPTUAL PLAN WAS BASED ON THE MANUFACTURER'S OPINION AND THE MANUFACTURER'S OPINION SHOULD BE PROVIDED AS INDICATED OR WITHIN THE ENTIRE USE ZONE.

CHANGES, INCLUDING ANY CHANGES, SHOULD BE MADE TO THE PLAN BEFORE CONSTRUCTION. THE MANUFACTURER'S OPINION SHOULD BE PROVIDED AS INDICATED OR WITHIN THE ENTIRE USE ZONE.

IT IS THE MANUFACTURER'S OPINION AND THE MANUFACTURER'S OPINION SHOULD BE PROVIDED AS INDICATED OR WITHIN THE ENTIRE USE ZONE.

DESIGNED BY:

JCA  
 601 W. STREET SOUTH - PALM BEACH, FL 33409  
 PHONE: 561-833-3300 FAX: 561-833-4772-4001

Date: \_\_\_\_\_ Previous Drawing #: \_\_\_\_\_ Index: \_\_\_\_\_

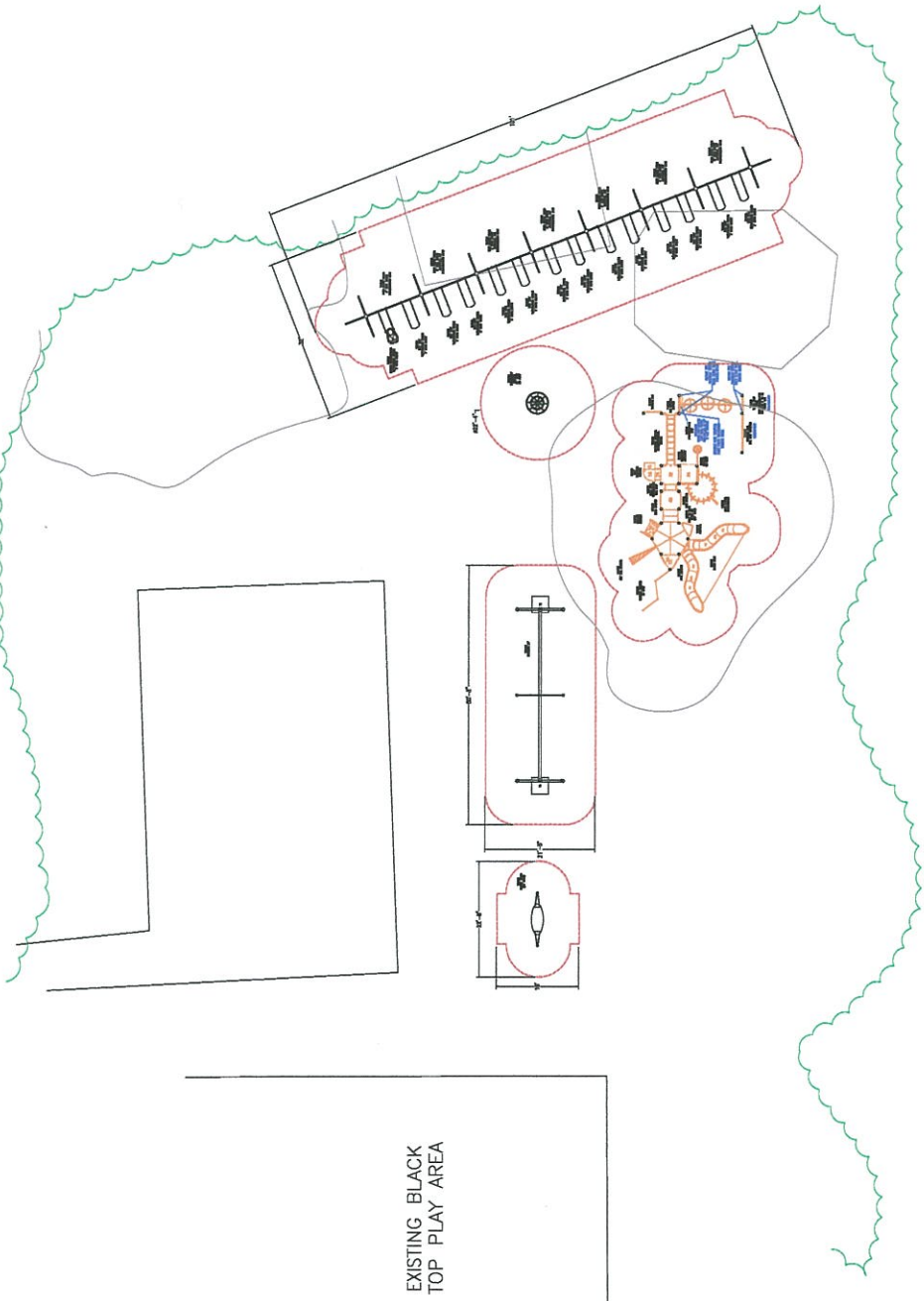

EXISTING BLACK  
TOP PLAY AREA

TOTAL ELEVATED PLAY COMPONENTS	8	REQUIRED	0
TOTAL ELEVATED COMPONENTS ACCESSIBLE BY RAMP	0	REQUIRED	4
TOTAL ELEVATED COMPONENTS ACCESSIBLE BY TRANSFER	8	REQUIRED	3
TOTAL ACCESSIBLE GROUND LEVEL COMPONENTS SHOWN	21	REQUIRED	6
TOTAL DIFFERENT TYPES OF GROUND LEVEL COMPONENTS	6	REQUIRED	6

83 West Street  
 PO Box 500  
 Palm Beach, FL 33402-0500  
 Phone 561-833-3300  
 Fax 561-833-2817



SYSTEM TYPE:  
PLAYBOOSTER/IND  
DRAWING #:  
MEO16072

M.E. O'BRIEN &  
SONS, INC.  
PETER WALLACE

HINDLEY ELEMENTARY SCHOOL  
DARIEN, CT

