

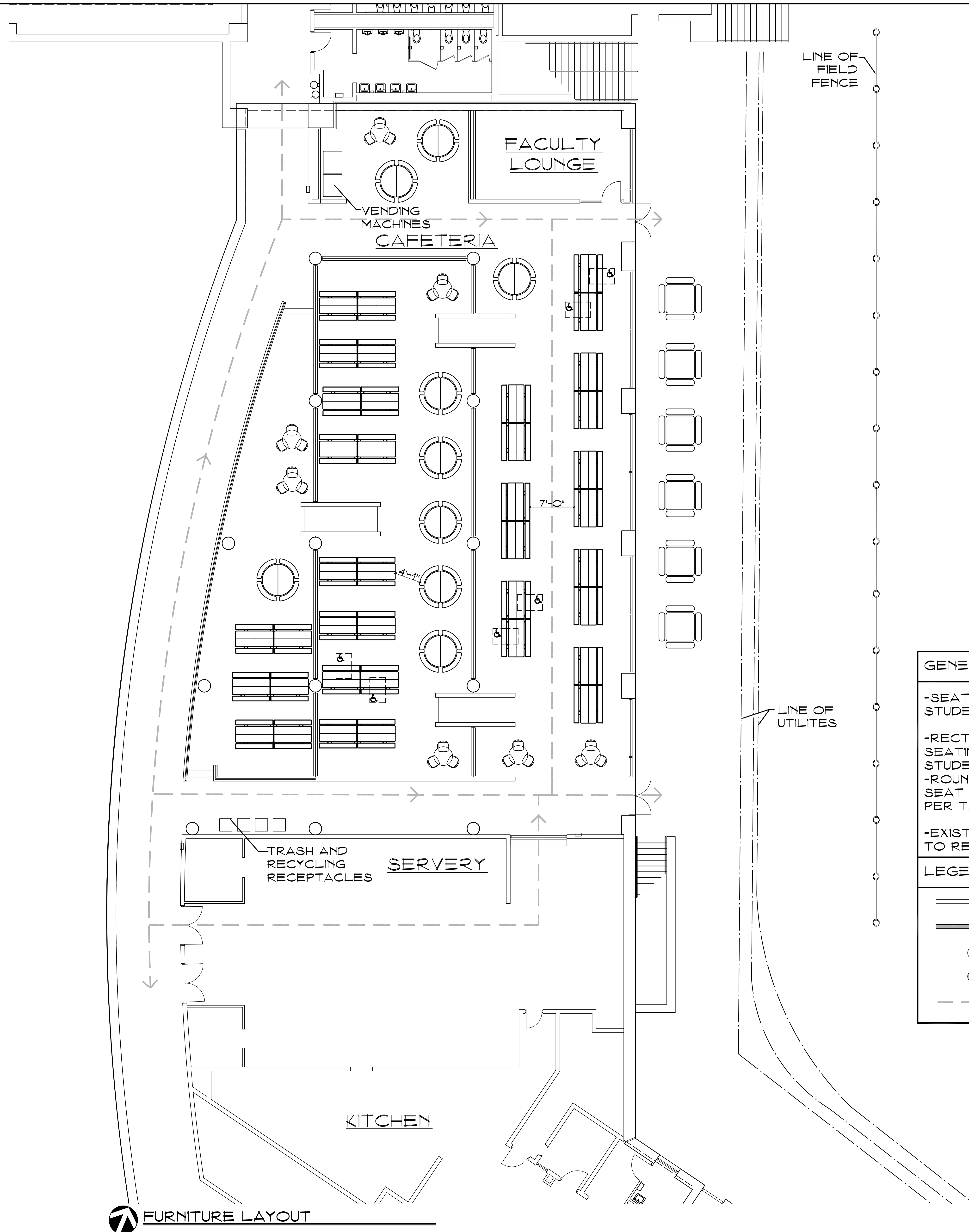

FURNITURE REFERENCES



FURNITURE LAYOUT

GENERAL NOTES

- SEATING INDOORS FOR 359 STUDENTS
- RECTANGULAR BENCH SEATING TO SEAT APPROX. 14 STUDENTS PER TABLE
- ROUND BENCH SEATING TO SEAT APPROX. 8 STUDENTS PER TABLE
- EXISTING FACULTY LOUNGE TO REMAIN

LEGEND

- EXISTING WALL
- NEW WALL
- EXISTING COLUMN
- NEW COLUMN
- - - - - PATH OF TRAVEL



Revision:	Description:	Date:	Revised By:



FURNITURE REFERENCES

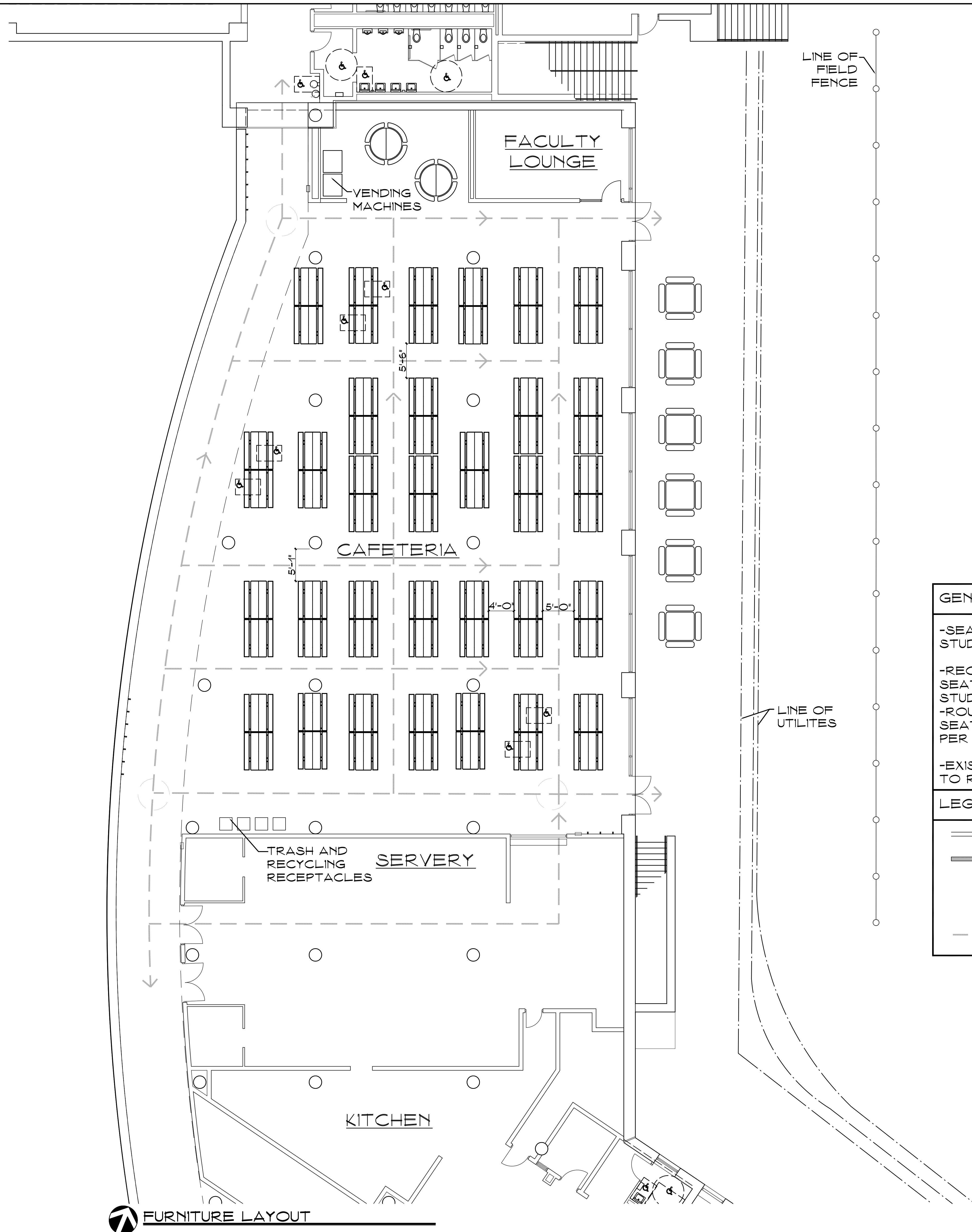

FURNITURE LAYOUT

GENERAL NOTES

- SEATING INDOORS FOR 450 STUDENTS
- RECTANGULAR BENCH SEATING TO SEAT APPROX. 14 STUDENTS PER TABLE
- ROUND BENCH SEATING TO SEAT APPROX. 8 STUDENTS PER TABLE
- EXISTING FACULTY LOUNGE TO REMAIN

LEGEND

- EXISTING WALL
- NEW WALL
- EXISTING COLUMN
- NEW COLUMN
- - - -> PATH OF TRAVEL



Revision:	Description:	Date:	Revised By: